

# Woolworths Leppington

## Landscape Development Application 116 Ingleburn Road, Leppington

### Drawing Schedule

Drawing Number	Drawing Title	Scale
000	Landscape Coversheet	N/A
001	Landscape Masterplan	1:300
002	Tree Canopy Cover	1:300
101	Landscape Plan	1:150
102	Landscape Plan	1:150
103	Landscape Plan	1:150
104	Landscape Plan	1:150
501	Landscape Details	As Shown
502	Landscape Details	As Shown
503	Landscape Details	As Shown
504	Landscape Specification	As Shown

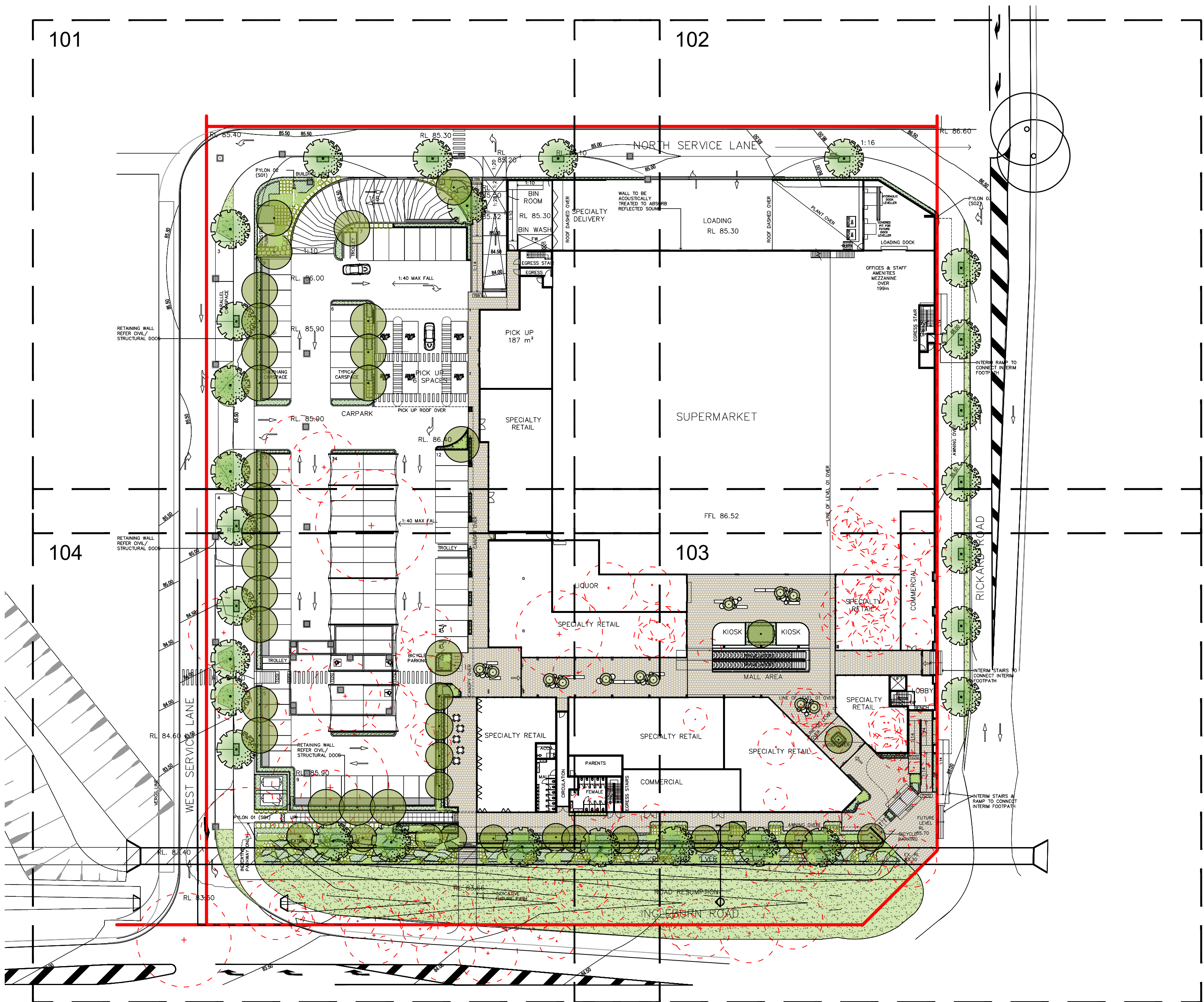

Site Plan | 1:500

NOT FOR CONSTRUCTION

© 2016 Site Image (NSW) Pty Ltd ABN 44 801 262 380 as agent for Site Image NSW Partnership. All rights reserved. This drawing is copyright and shall not be reproduced or copied in any form or by any means (graphic, electronic or mechanical including photocopy) without the written permission of Site Image (NSW) Pty Ltd Any license, expressed or implied, to use this document for any purpose what so ever is restricted to the terms of the written agreement between Site Image (NSW) Pty Ltd and the instructing party.

The contractor shall check and verify all work on site (including work by others) before commencing the landscape installation. Any discrepancies are to be reported to the Project Manager or Landscape Architect prior to commencing work. Do not scale this drawing. Any required dimensions not shown shall be referred to the Landscape Architect for confirmation.

F	Architectural Coordination	JM	NM	02.02.2021
E	Architectural Coordination	JM	NM	13.11.2020
D	Architectural Coordination	JM	NM	24.09.2020
C	Updated Civil Drawings	SM	NM	30.03.2020
B	Architectural Coordination	JM	NM	25.03.2020
A	For Review	JM	NM	17.02.2020
Issue	Revision Description	Drawn	Check	Date

### LEGEND

Client:  
Fabcot Pty Ltd

Project:  
Woolworths Leppington  
116 Ingleburn Road, Leppington

**SITE IMAGE**  
Level 1, 3-5 Baptist Street  
Redfern NSW 2016  
Australia  
Tel: (61 2) 8332 5600  
Fax: (61 2) 9698 2877  
www.siteimage.com.au  
Site Image (NSW) Pty Ltd  
ABN 44 801 262 380  
Landscape Architects

### DEVELOPMENT APPLICATION

Drawing Name:  
Landscape Coversheet

Scale:  
Job Number:  
Drawing Number:  
Issue:  
SS20-4303  
000 F



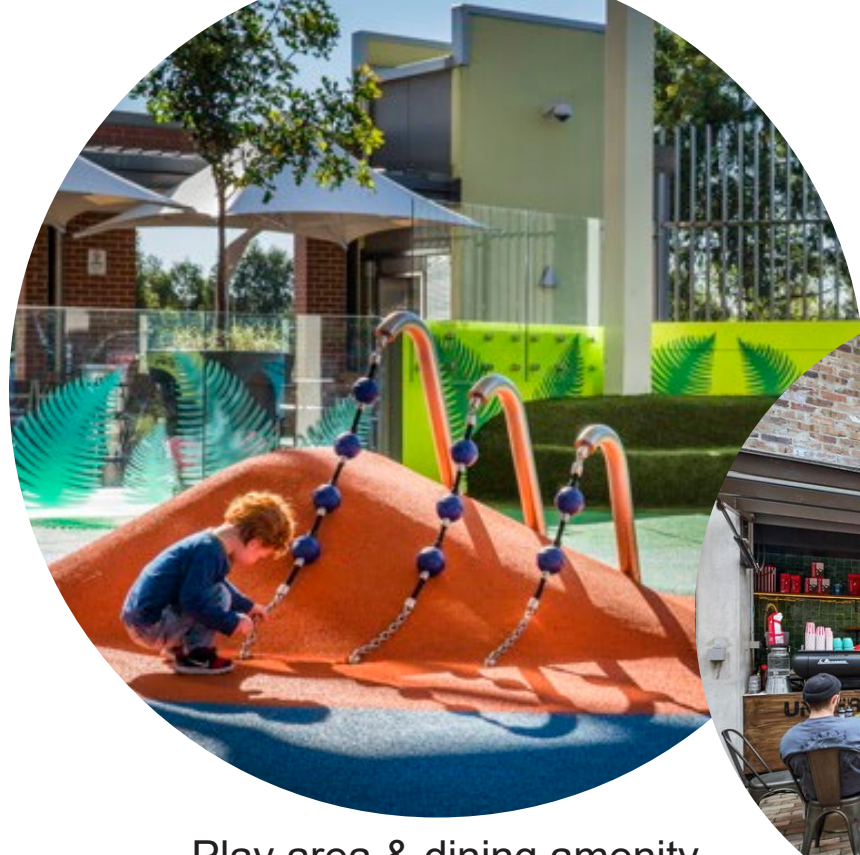



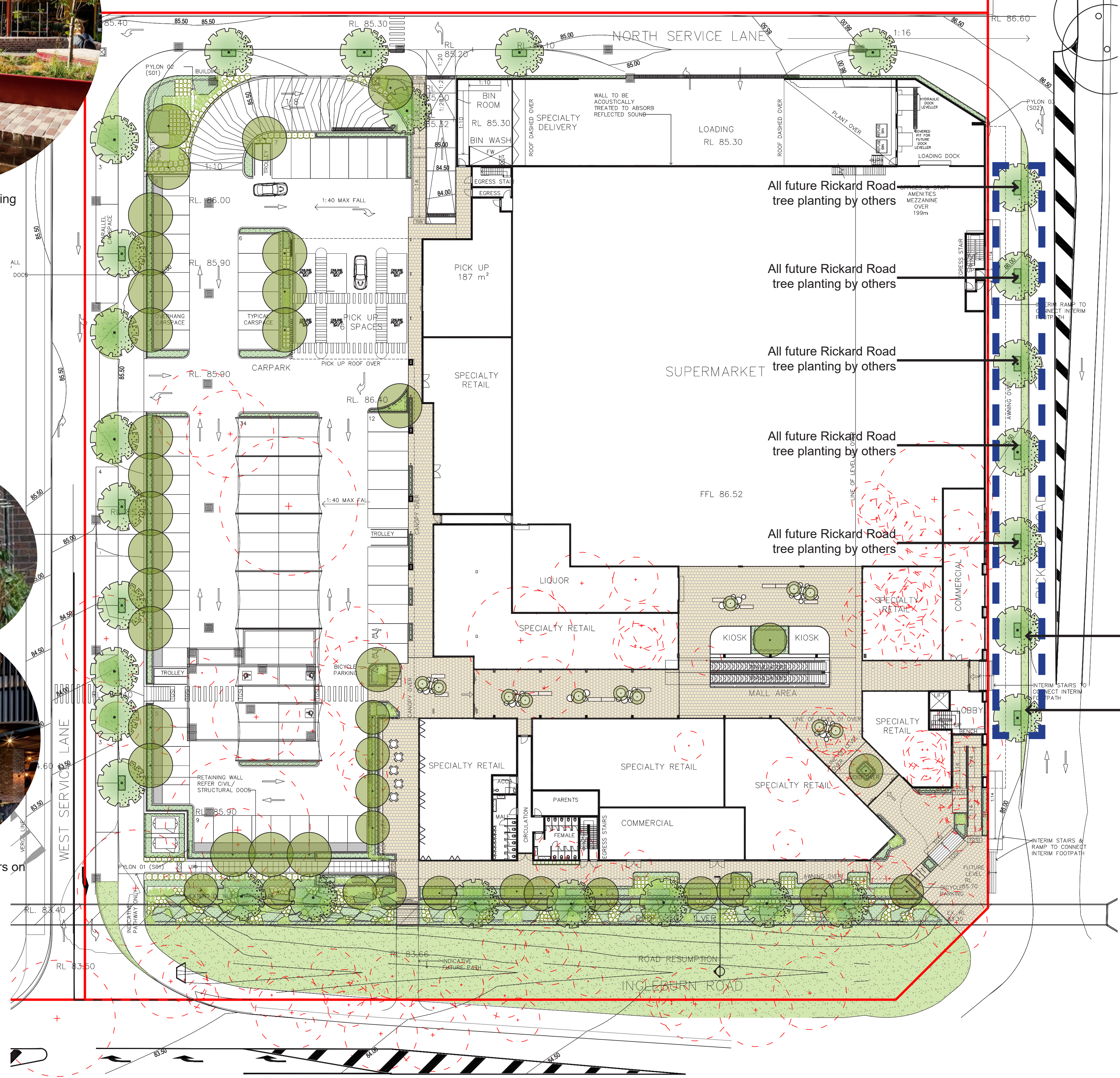







Note: Figure 4.8 of schedule 2 of the DCP calls for street trees only to be planted at intersections. The proposal seeks to challenge the DCP with additional street trees proposed on North service lane to help screen loading dock from adjacent developments.



F	Architectural Coordination	JM	NM	02.02.2021
E	Architectural Coordination	JM	NM	13.11.2020
D	Architectural Coordination	JM	NM	24.09.2020
C	Updated Civil Drawings	SM	NM	30.03.2020
B	Architectural Coordination	JM	NM	25.03.2020
A	For Review	JM	NM	17.02.2020
Issue	Revision Description	Drawn	Check	Date

- LEGEND**

  -  Property Boundary
  -  Basement Line
  -  Existing Tree Retained
  -  Existing Tree to be Removed
  -  Proposed Tree
  -  Proposed Shrubs/ Accents
  -  Proposed Groundcover/ Grasses
  -  Turf
  -  Unit Paving  
400x400 Stretcher Semi Honed  
Colour: TBC
  -  Insitu Concrete Footpath  
Colour: Standard Grey

The contractor shall check and verify all work on site (including work by others) before commencing the landscape installation. Any discrepancies are to be reported to the Project Manager or Landscape Architect prior to commencing work. Do not scale this drawing. Any required dimensions not shown shall be referred to the Landscape Architect for confirmation.

- All future Rickard Road tree planting by others

- All future Rickard Road tree planting by others

Client:  
**Fabcot Pty Ltd**

Project:

Woolworths Leppington

116 Ingleburn Road, Leppington

SITE IMAGE

Level 1, 3-5 Baptist Street  
Redfern NSW 2016  
Australia

Tel: (61 2) 8332 5600  
Fax: (61 2) 9698 2877  
[www.siteimage.com.au](http://www.siteimage.com.au)

Site Image (NSW) Pty Ltd  
ABN 44 801 262 380



## DEVELOPMENT APPLICATION

Drawing Name:

Landscape Masterplan

Scale: 1:300 @ A1

Job Number: \_\_\_\_\_ Drawing Number: \_\_\_\_\_ Issue: \_\_\_\_\_

NOT FOR CONSTRUCTION



The contractor shall check and verify all work on site (including work by others) before commencing the landscape installation. Any discrepancies are to be reported to the Project Manager or Landscape Architect prior to commencing work. Do not scale this drawing. Any required dimensions not shown shall be referred to the Landscape Architect for confirmation.

F	Architectural Coordination	JM	NM	02.02.2021
E	Architectural Coordination	JM	NM	13.11.2020
D	Architectural Coordination	JM	NM	24.09.2020
SM	Updated Civil Drawings	SM	NM	30.03.2020
C	Architectural Coordination	JM	NM	25.03.2020
A	For Review	JM	NM	17.02.2020
Issue	Revision Description	Drawn	Check	Date

LEGEND	
	Car Park Area 1300m <sup>2</sup>
	Tree Canopy Cover 228m <sup>2</sup> (17.5%)
	Shade Sail Cover 482m <sup>2</sup> (37%)
	Total Shade Cover 710m <sup>2</sup> (54.5%)

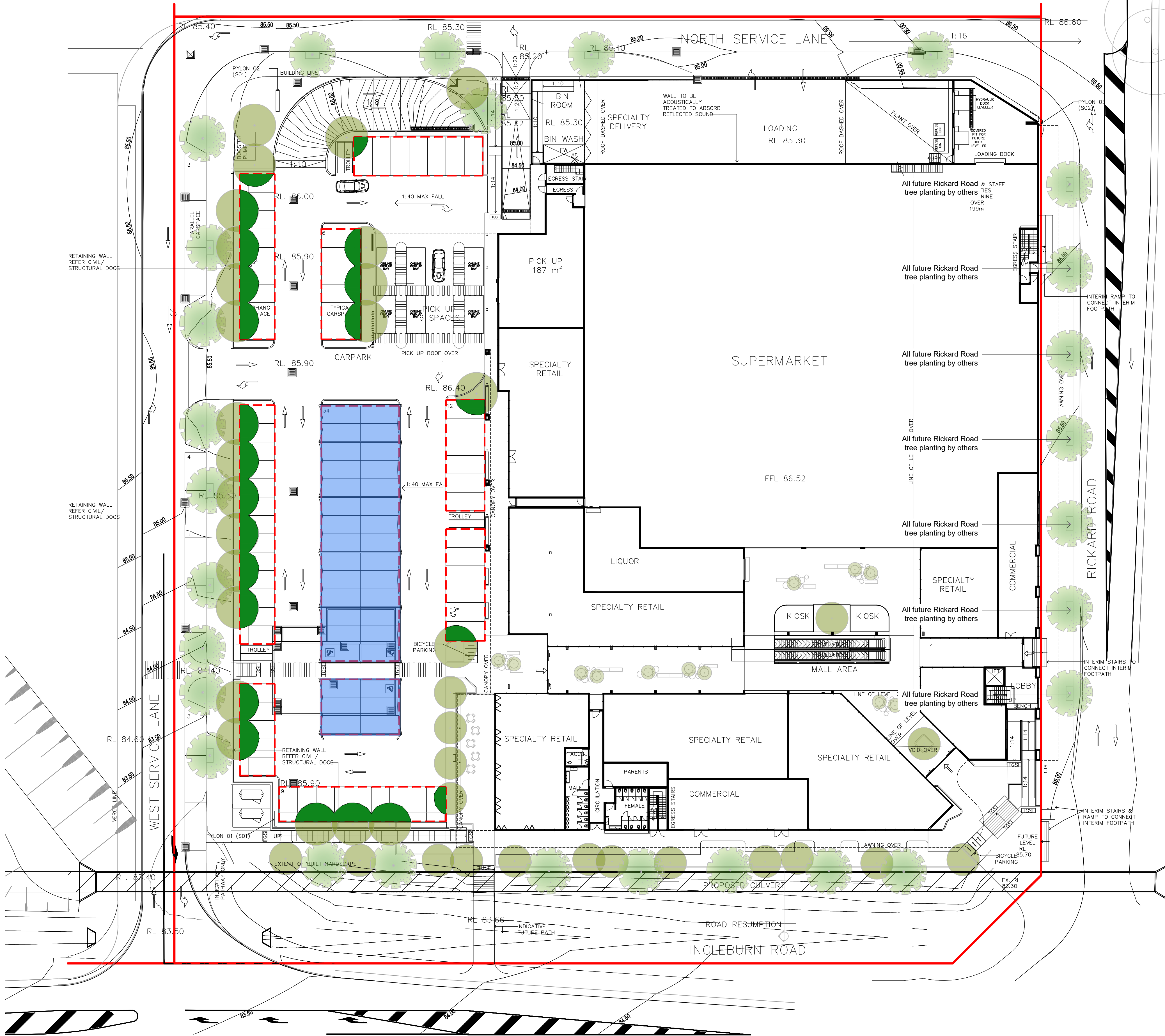

Client:  
Fabcot Pty Ltd

Project:  
Woolworths Leppington  
116 Ingleburn Road, Leppington

**SITE IMAGE**  
Level 1, 3-5 Baptist Street  
Redfern NSW 2016  
Australia  
Tel: (61 2) 8332 5600  
Fax: (61 2) 9698 2877  
www.siteimage.com.au  
Site Image (NSW) Pty Ltd  
ABN 44 801 262 380  
Landscape Architects

DEVELOPMENT APPLICATION

Drawing Name:  
Carpark Tree Canopy Cover

Scale: 1:300 @ A1  
Job Number: SS20-4303  
Drawing Number: 002  
Issue: F

NOT FOR CONSTRUCTION



The contractor shall check and verify all work on site (including work by others) before commencing the landscape installation. Any discrepancies are to be reported to the Project Manager or Landscape Architect prior to commencing work. Do not scale this drawing. Any required dimensions not shown shall be referred to the Landscape Architect for confirmation.

F	Architectural Coordination	JM	NM	02.02.2021
E	Architectural Coordination	JM	NM	13.11.2020
D	Architectural Coordination	JM	NM	24.09.2020
C	Updated Civil Drawings	SM	NM	30.03.2020
B	Architectural Coordination	JM	NM	25.03.2020
A	For Review	JM	NM	17.02.2020
Issue	Revision Description	Drawn	Check	Date

- LEGEND**
- Property Boundary
  - Basement Line
  - Existing Tree Retained
  - Proposed Tree
  - Proposed Shrubs/ Accents
  - Proposed Groundcover/ Grasses
  - Turf
  - Unit Paving  
400x400 Stretcher Semi Honed  
Colour: TBC

Client:  
**Fabcot Pty Ltd**

Project:  
**Woolworths Leppington**  
116 Ingleburn Road, Leppington

**SITE IMAGE**  
Level 1, 3-5 Baptist Street  
Redfern NSW 2016  
Australia  
Tel: (61 2) 8332 5600  
Fax: (61 2) 9698 2877  
www.siteimage.com.au  
Site Image (NSW) Pty Ltd  
ABN 44 801 262 380  
Landscape Architects

**DEVELOPMENT APPLICATION**

Drawing Name:  
**Landscape Plan**

Scale: 1:150 @ A1  
Job Number:  
**SS20-4303**  
Drawing Number:  
**101**  
Issue:  
**F**



NOT FOR CONSTRUCTION



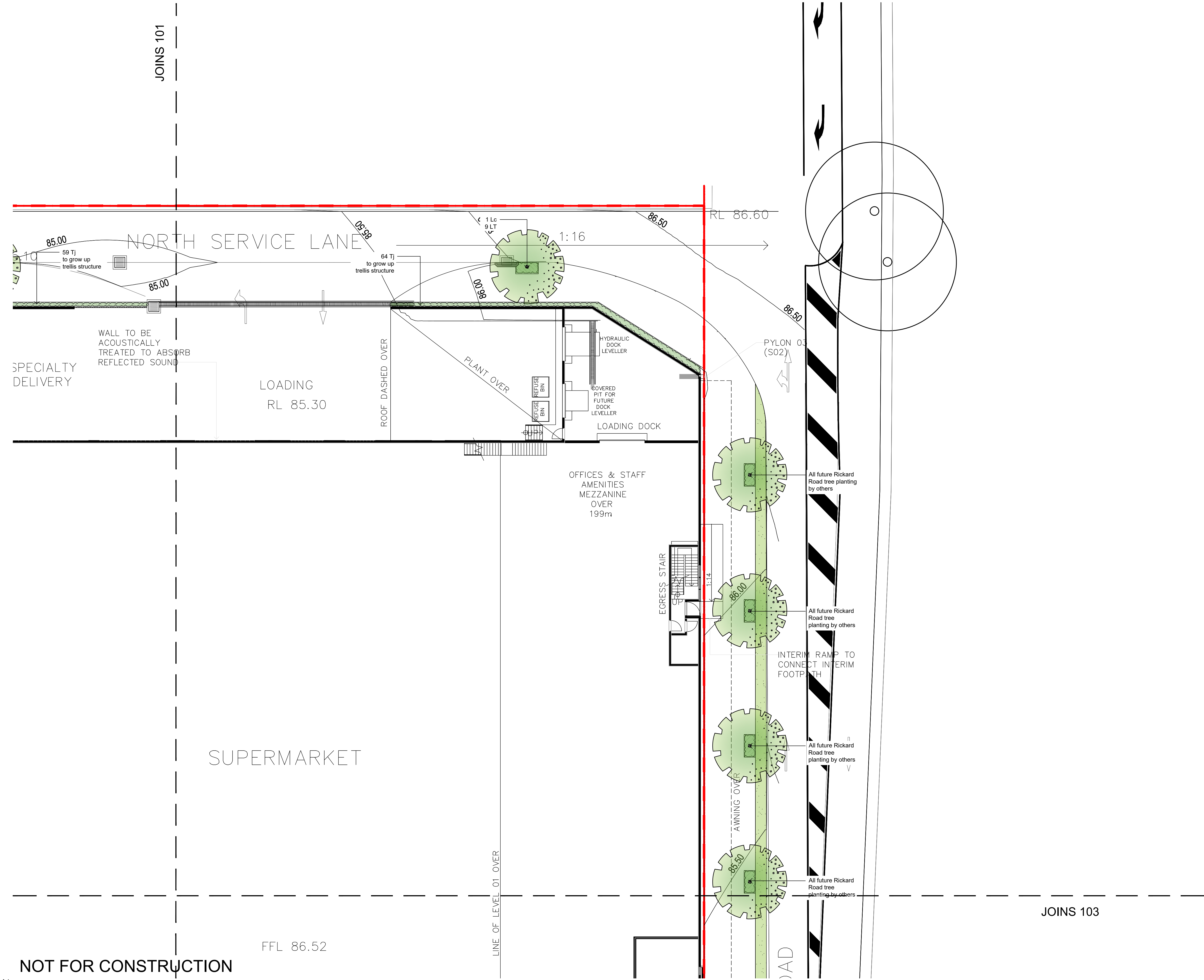





© 2016 Site Image (NSW) Pty Ltd ABN 44 801 262 380 as agent for Site Image NSW Partnership. All rights reserved. This drawing is copyright and shall not be reproduced or copied in any form or by any means (graphic, electronic or mechanical including photocopy) without the written permission of Site Image (NSW) Pty Ltd Any license, expressed or implied, to use this document for any purpose what so ever is restricted to the terms of the written agreement between Site Image (NSW) Pty Ltd and the instructing party.

The contractor shall check and verify all work on site (including working by others) before commencing the landscape installation. Any discrepancies are to be reported to the Project Manager or Landscape Architect prior to commencing work. Do not scale this drawing. Any required dimensions not shown shall be referred to the Landscape Architect for confirmation.

F	Architectural Coordination	JM	NM	02.02.2021
E	Architectural Coordination	JM	NM	13.11.2020
D	Architectural Coordination	JM	NM	24.09.2020
C	Updated Civil Drawings	SM	NM	30.03.2020
B	Architectural Coordination	JM	NM	25.03.2020
A	For Review	JM	NM	17.02.2020
Issue	Revision Description	Drawn	Check	Date

- LEGEND
- Property Boundary
  - Basement Line
  - Existing Tree Retained
  - Proposed Tree
  - Proposed Shrubs/ Accents
  - Proposed Groundcover/ Grasses
  - Turf
  - Unit Paving  
400x400 Stretcher Semi Honed  
Colour: TBC

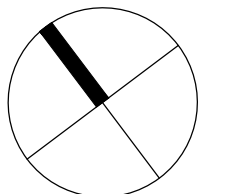

Client:  
Fabcot Pty Ltd

Project:  
Woolworths Leppington  
116 Ingleburn Road, Leppington

SITE IMAGE  
Level 1, 3-5 Baptist Street  
Redfern NSW 2016  
Australia  
Tel: (61 2) 8332 5600  
Fax: (61 2) 9698 2877  
www.siteimage.com.au  
Site Image (NSW) Pty Ltd  
ABN 44 801 262 380  
Landscape Architects

DEVELOPMENT APPLICATION

Drawing Name:  
Landscape Plan

Scale: 1:150 @ A1  
Job Number:  
Drawing Number:  
Issue:

SS20-4303 103 F





© 2016 Site Image (NSW) Pty Ltd ABN 44 801 262 380 as agent for Site Image NSW Partnership. All rights reserved. This drawing is copyright and shall not be reproduced or copied in any form or by any means (graphic, electronic or mechanical including photocopy) without the written permission of Site Image (NSW) Pty Ltd Any license, expressed or implied, to use this document for any purpose what so ever is restricted to the terms of the written agreement between Site Image (NSW) Pty Ltd and the instructing party.

The contractor shall check and verify all work on site (including work by others) before commencing the landscape installation. Any discrepancies are to be reported to the Project Manager or Landscape Architect prior to commencing work. Do not scale this drawing. Any required dimensions not shown shall be referred to the Landscape Architect for confirmation.

F	Architectural Coordination	JM	NM	02.02.2021
E	Architectural Coordination	JM	NM	13.11.2020
D	Architectural Coordination	JM	NM	24.09.2020
C	Updated Civil Drawings	SM	NM	30.03.2020
B	Architectural Coordination	JM	NM	25.03.2020
A	For Review	JM	NM	17.02.2020
Issue	Revision Description	Drawn	Check	Date

- LEGEND
- Property Boundary
  - Basement Line
  - Existing Tree Retained
  - Proposed Tree
  - Proposed Shrubs/ Accents
  - Proposed Groundcover/ Grasses
  - Turf
  - Unit Paving  
400x400 Stretcher Semi Honed  
Colour: TBC

Client:  
Fabcot Pty Ltd

Project:  
Woolworths Leppington  
116 Ingleburn Road, Leppington

SITE IMAGE  
Level 1, 3-5 Baptist Street  
Redfern NSW 2016  
Australia  
Tel: (61 2) 8332 5600  
Fax: (61 2) 9698 2877  
www.siteimage.com.au  
Site Image (NSW) Pty Ltd  
ABN 44 801 262 380

DEVELOPMENT APPLICATION

Drawing Name:  
Landscape Plan

Scale: 1:150 @ A1  
Job Number:  
Drawing Number:  
Issue:

SS20-4303 104 F



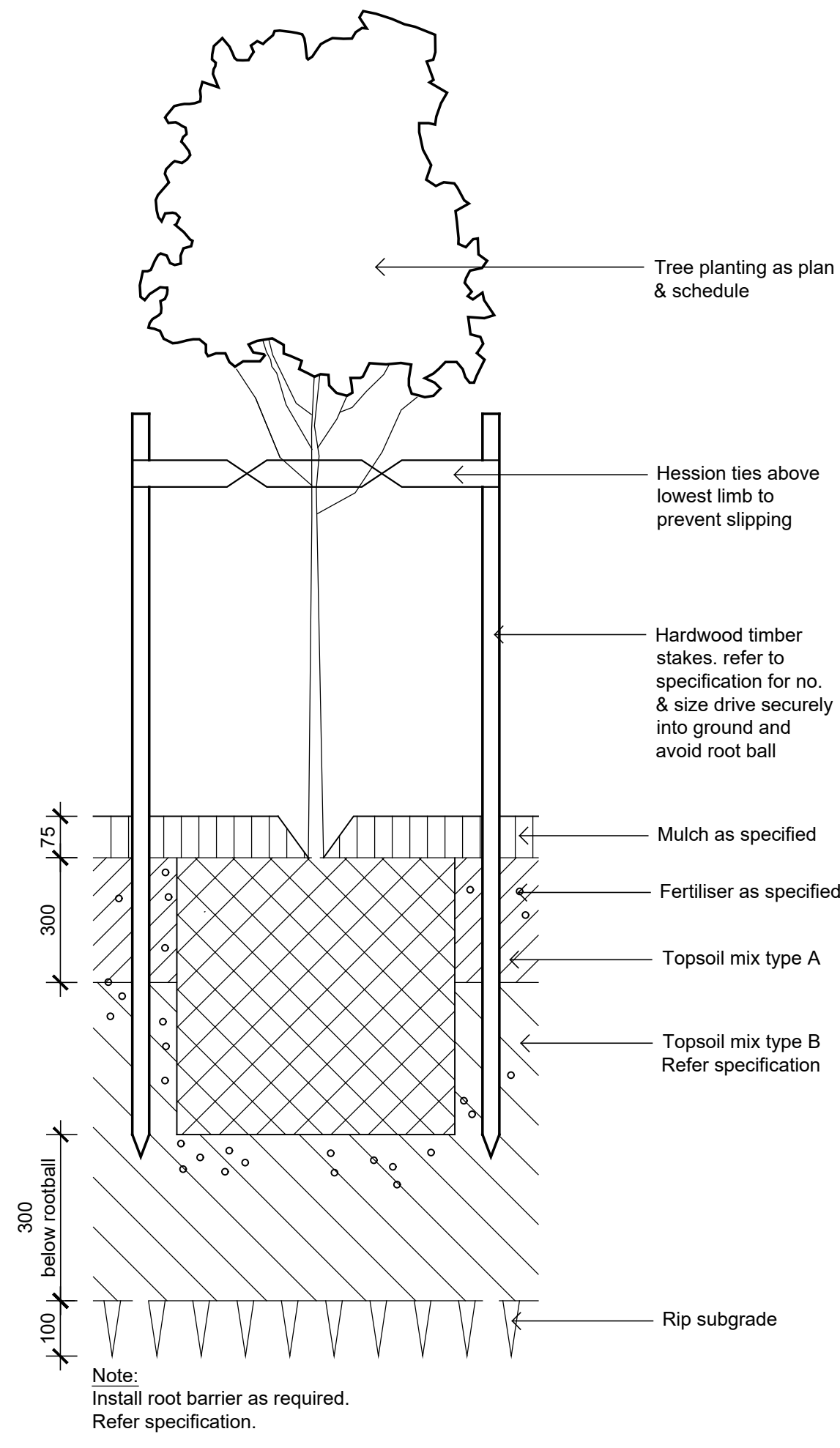

Detail 75-200L Tree Planting on Grade  
1:10

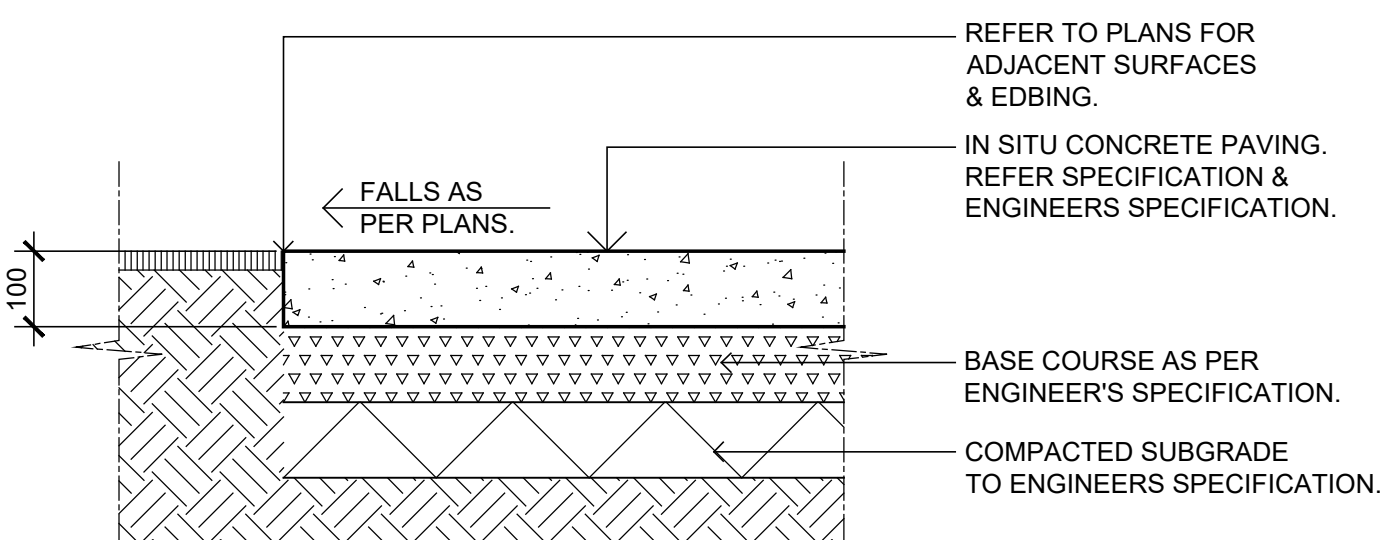

INSITU CONCRETE PAVING  
SCALE 1:10

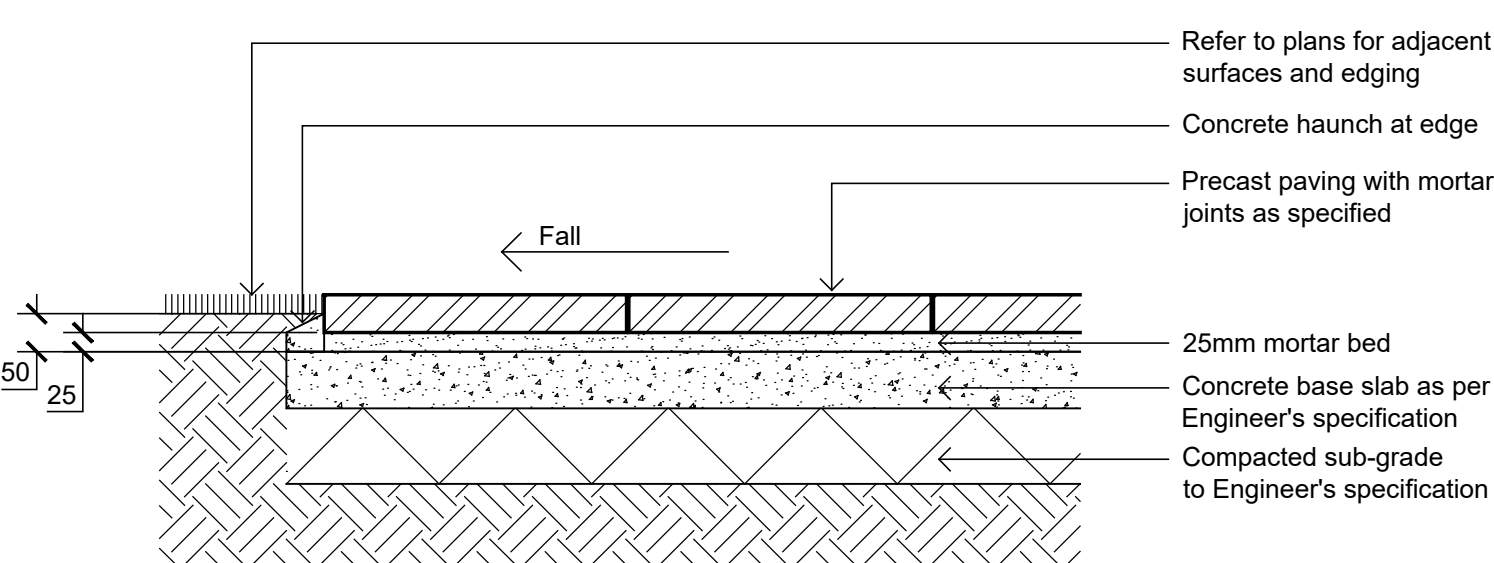

PRECAST UNIT PAVERS ON CONC SLAB  
SCALE 1:10

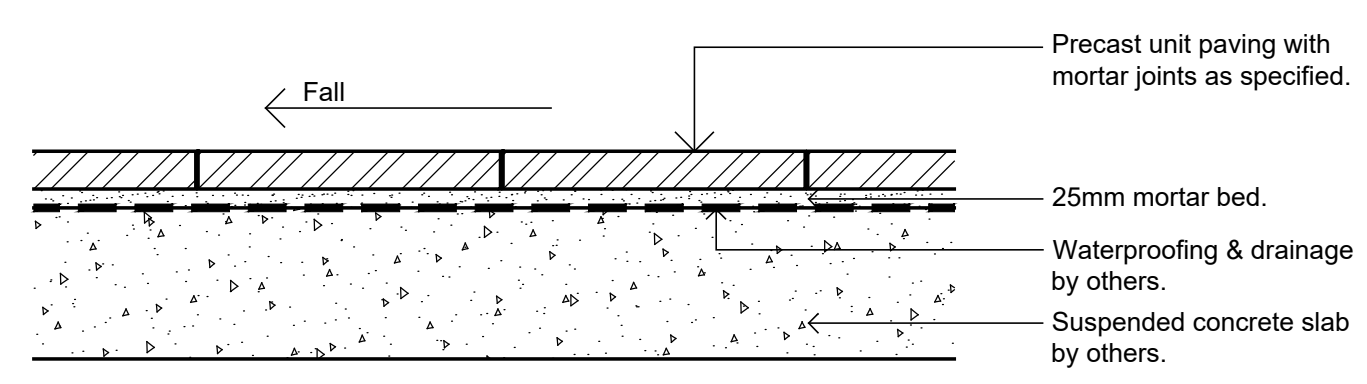

PRECAST UNIT PAVERS ON SUSPENDED SLAB  
SCALE 1:10

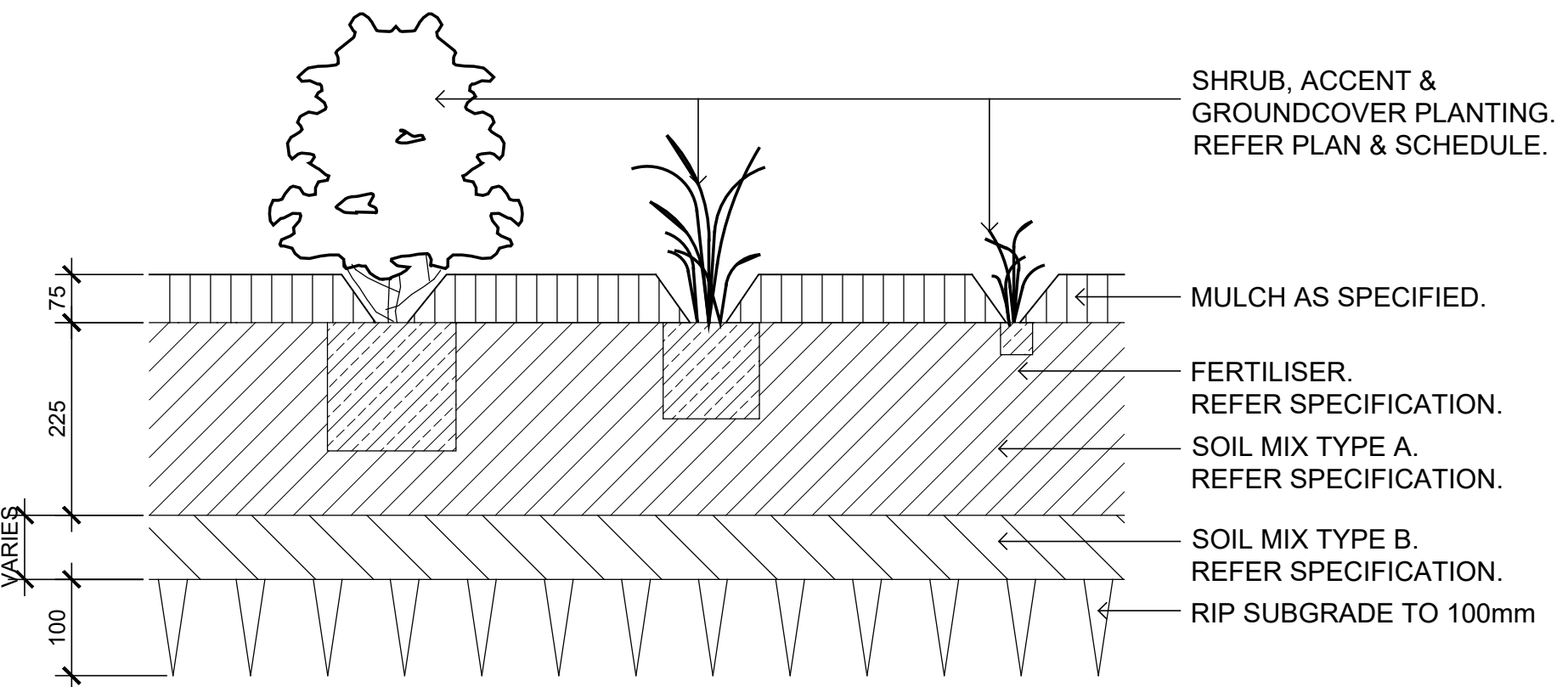

SHRUB, ACCENT & GROUND COVER PLANTING ON GRADE  
SCALE 1:10

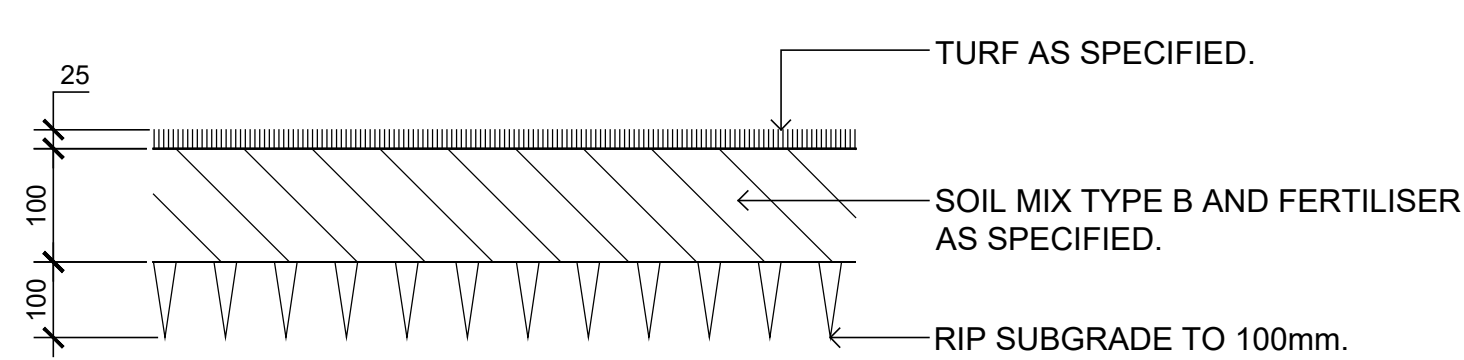

TURF ON EVEN GRADE  
SCALE 1:10

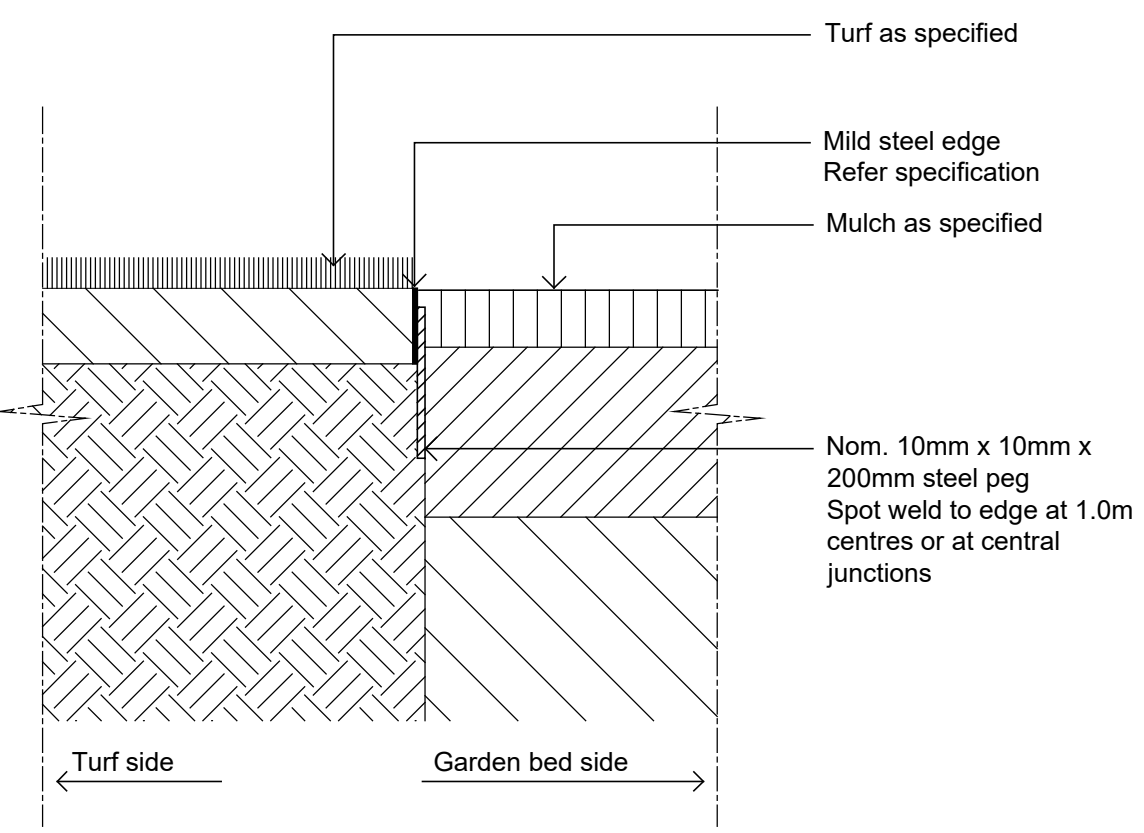

TYPICAL MILD STEEL EDGE  
SCALE 1:10

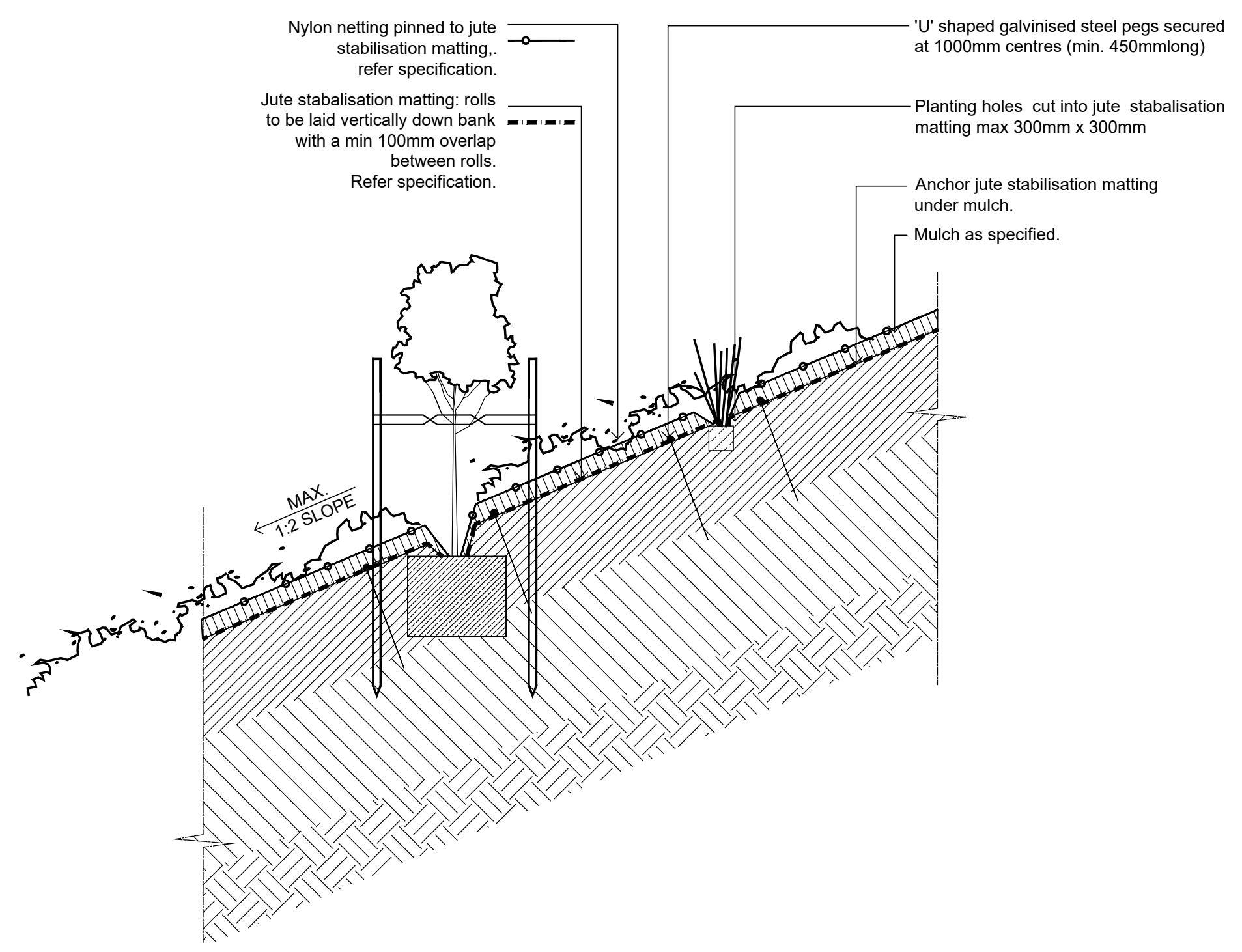

Typical Embankment Planting  
1:20

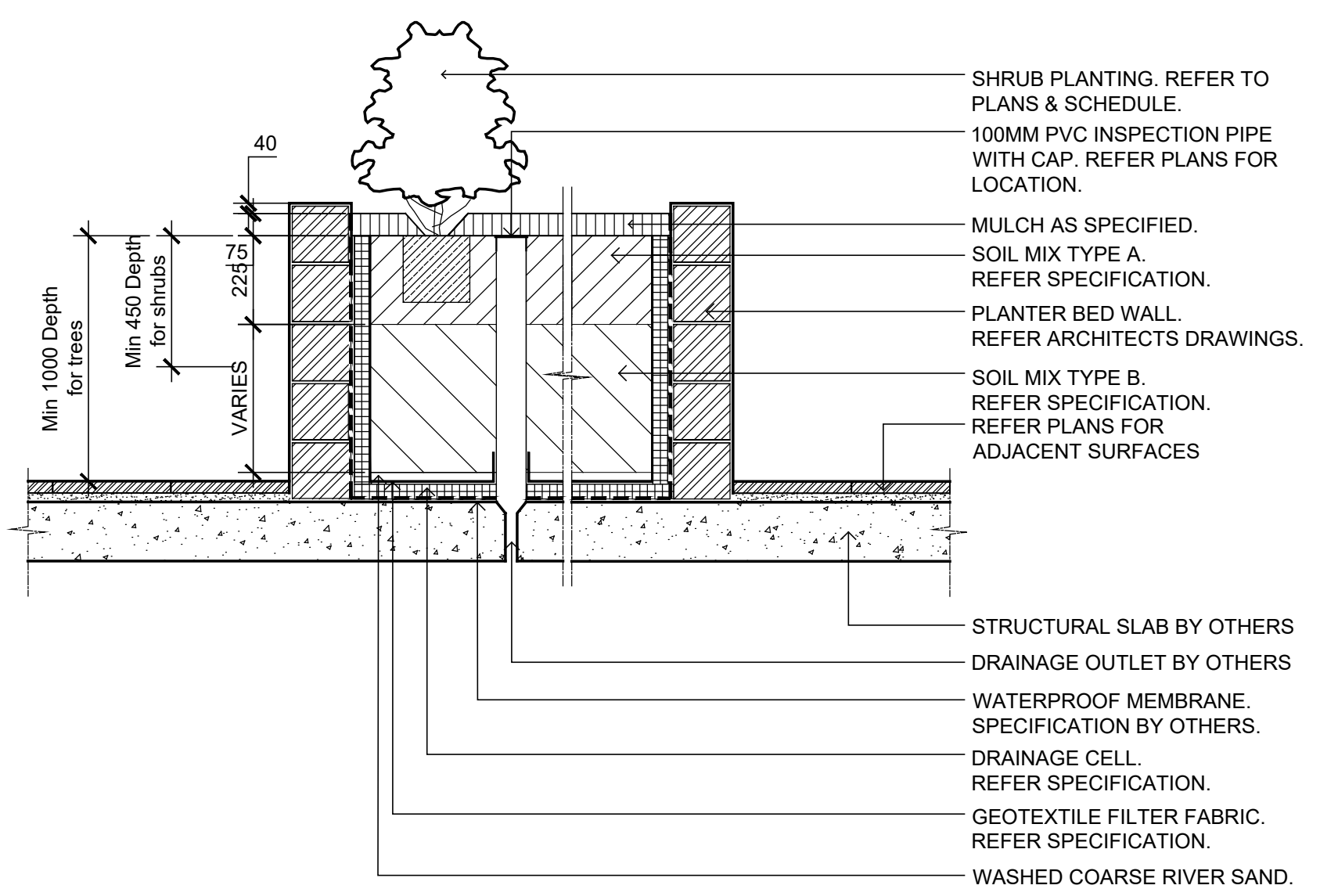

TYP. RAISED PLANTER BED ON SUSPENDED SLAB - SECTION  
SCALE 1:20

© 2016 Site Image (NSW) Pty Ltd ABN 44 801 262 380 as agent for Site Image NSW Partnership. All rights reserved. This drawing is copyright and shall not be reproduced or copied in any form or by any means (graphic, electronic or mechanical including photocopy) without the written permission of Site Image (NSW) Pty Ltd Any license, expressed or implied, to use this document for any purpose what so ever is restricted to the terms of the written agreement between Site Image (NSW) Pty Ltd and the instructing party.

The contractor shall check and verify all work on site (including work by others) before commencing the landscape installation. Any discrepancies are to be reported to the Project Manager or Landscape Architect prior to commencing work. Do not scale this drawing. Any required dimensions not shown shall be referred to the Landscape Architect for confirmation.

F	Architectural Coordination	JM	NM	02.02.2021
E	Architectural Coordination	JM	NM	13.11.2020
D	Architectural Coordination	JM	NM	24.09.2020
C	Updated Civil Drawings	SM	NM	30.03.2020
B	Architectural Coordination	JM	NM	25.03.2020
A	For Review	JM	NM	17.02.2020
Issue	Revision Description	Drawn	Check	Date

LEGEND

Client:  
**Fabcot Pty Ltd**

Project:  
**Woolworths Leppington**  
**116 Ingleburn Road, Leppington**

**SITE IMAGE**

Level 1, 3-5 Baptist Street  
Redfern NSW 2016  
Australia

Tel: (61 2) 8332 5600  
Fax: (61 2) 9698 2877  
www.siteimage.com.au

Site Image (NSW) Pty Ltd  
ABN 44 801 262 380

Landscape Architects

DEVELOPMENT APPLICATION

Drawing Name:  
**Landscape Details**

Scale: As Shown  
Job Number: SS20-4303  
Drawing Number: 501  
Issue: F

NOT FOR CONSTRUCTION



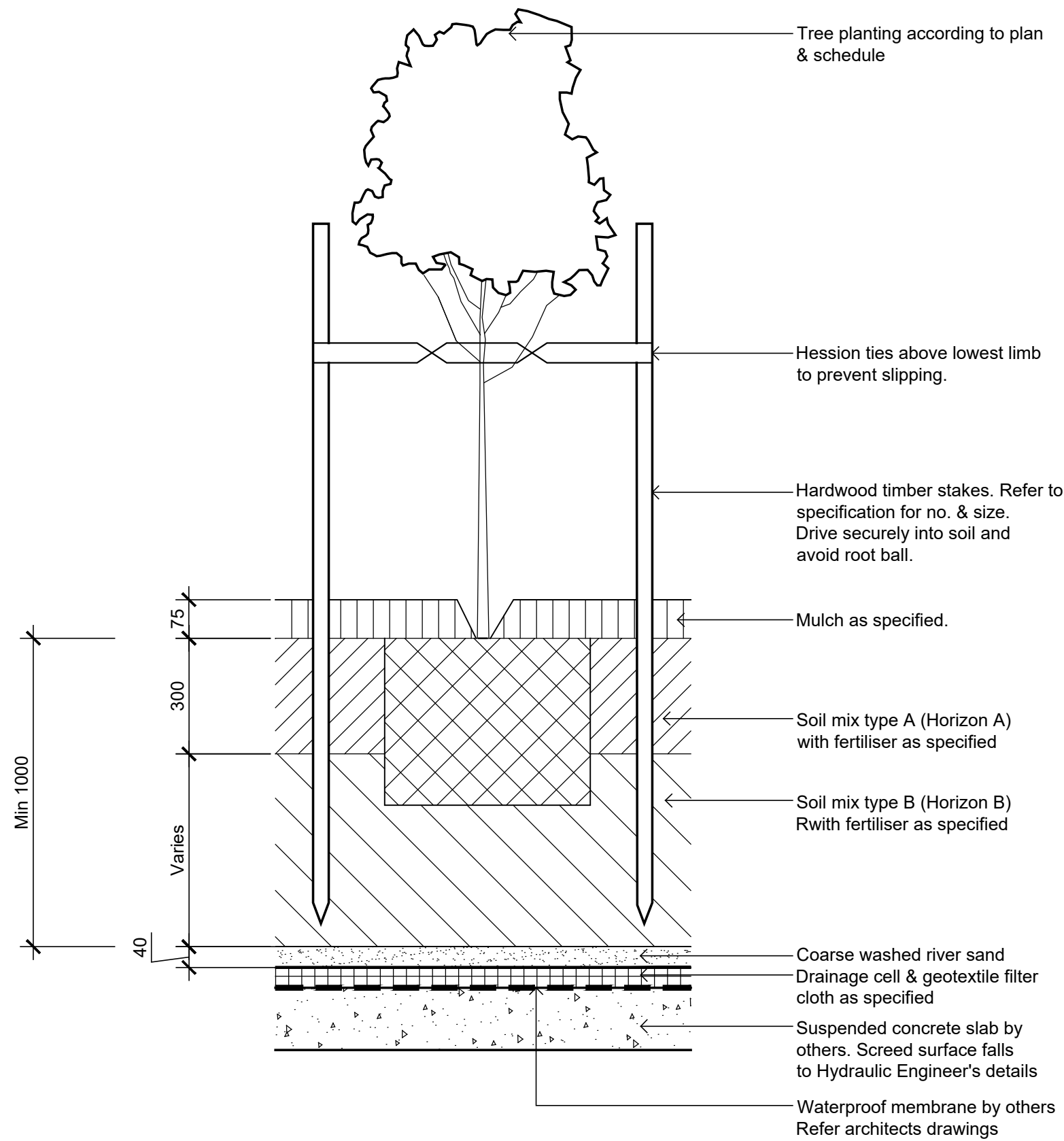

Detail 25-75L Tree Planting on Structure  
1:10

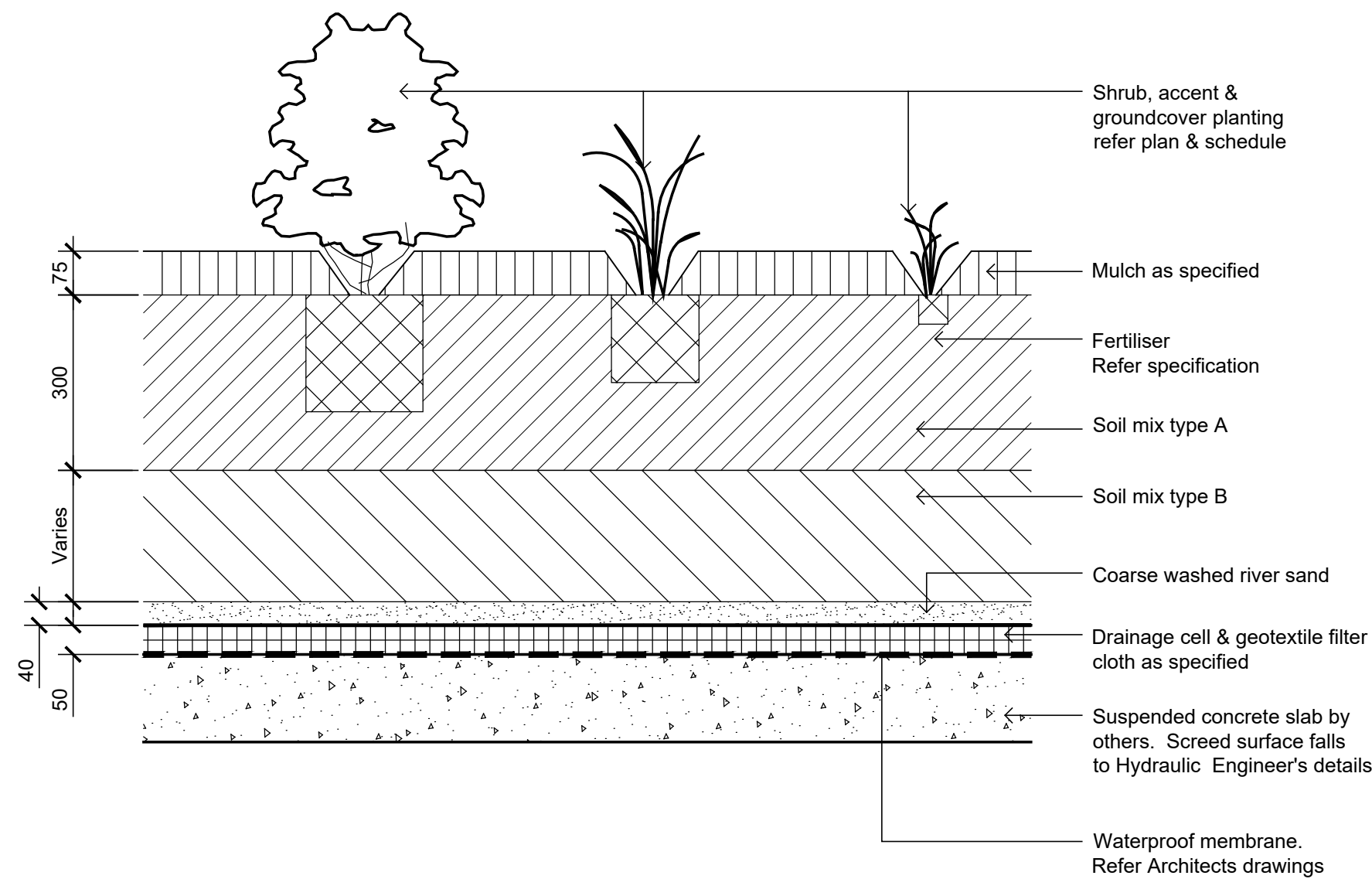

Detail Shrub Accent & Groundcover Planting on Structure  
1:10

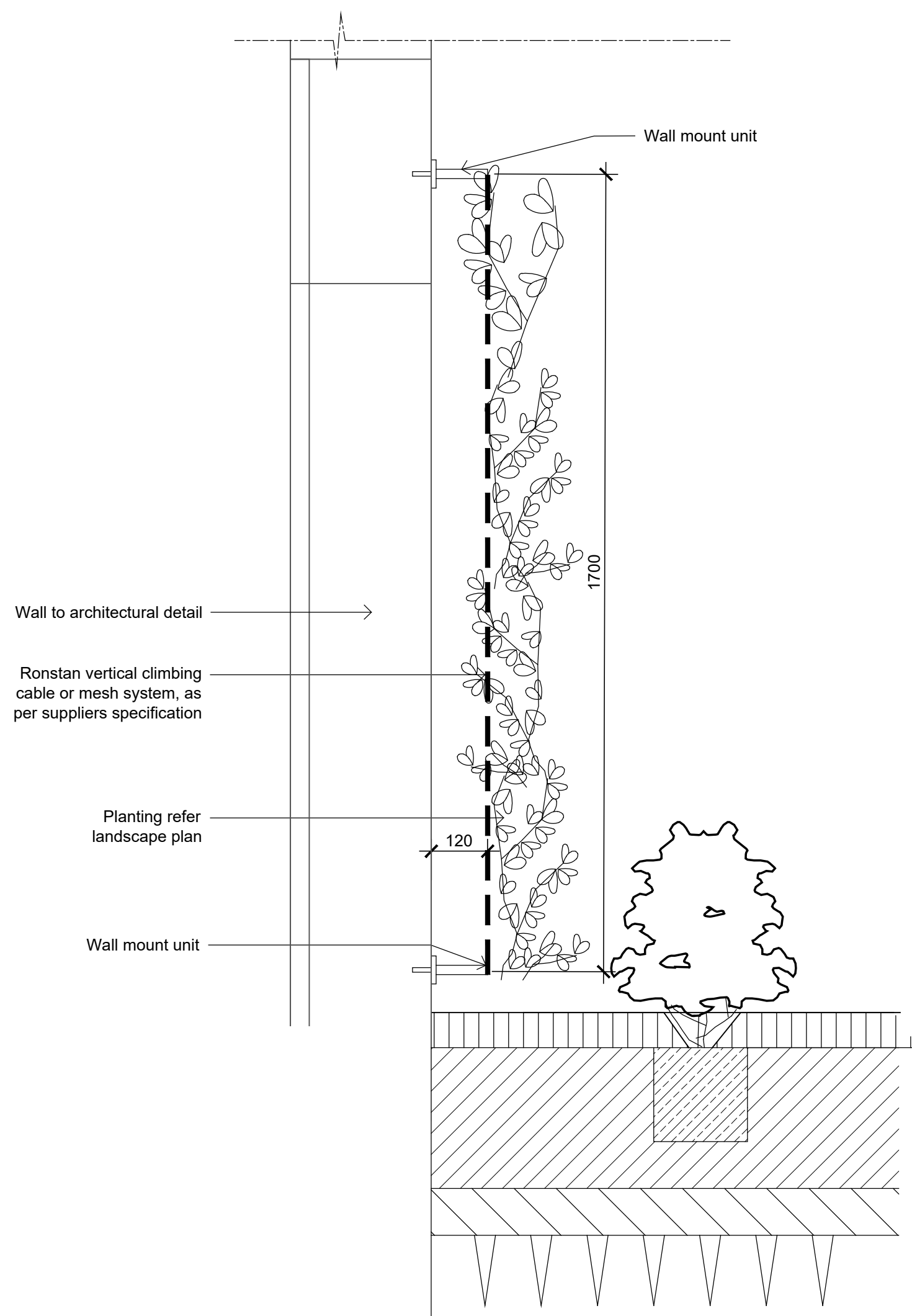

Typical Trellis Detail on grade  
1:10

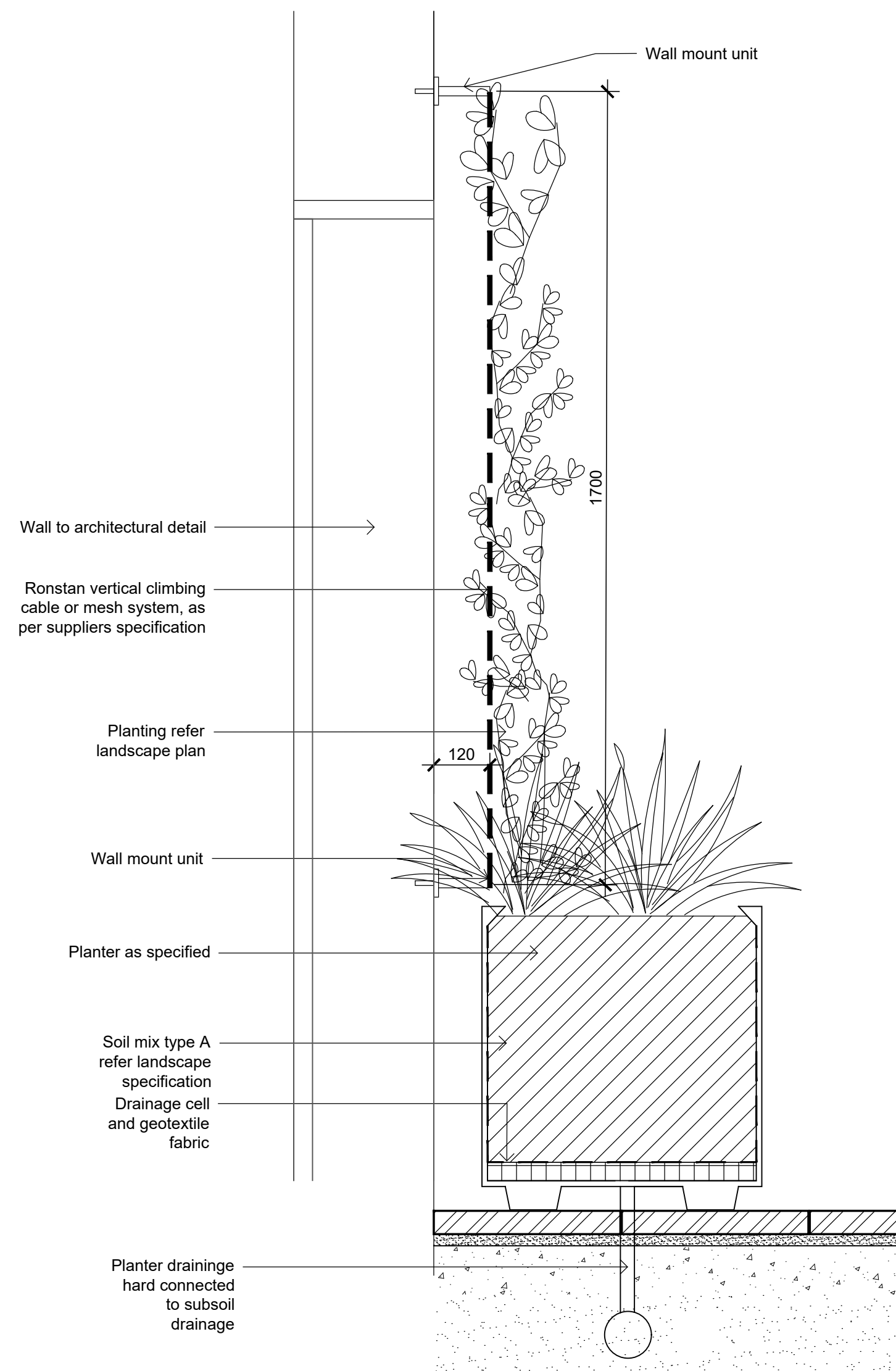

Typical Trellis Detail on structure  
1:10

© 2016 Site Image (NSW) Pty Ltd ABN 44 801 262 380 as agent for Site Image NSW Partnership. All rights reserved. This drawing is copyright and shall not be reproduced or copied in any form or by any means (graphic, electronic or mechanical including photocopy) without the written permission of Site Image (NSW) Pty Ltd Any license, expressed or implied, to use this document for any purpose what so ever is restricted to the terms of the written agreement between Site Image (NSW) Pty Ltd and the instructing party.

The contractor shall check and verify all work on site (including work by others) before commencing the landscape installation. Any discrepancies are to be reported to the Project Manager or Landscape Architect prior to commencing work. Do not scale this drawing. Any required dimensions not shown shall be referred to the Landscape Architect for confirmation.

F	Architectural Coordination	JM	NM	02.02.201
E	Architectural Coordination	JM	NM	13.11.2020
D	Architectural Coordination	JM	NM	24.09.2020
C	Updated Civil Drawings	SM	NM	30.03.2020
B	Architectural Coordination	JM	NM	25.03.2020
A	For Review	JM	NM	17.02.2020
Issue	Revision Description	Drawn	Check	Date

#### LEGEND

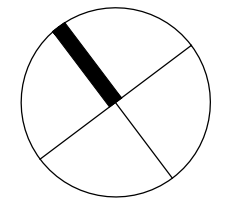

Client:

Fabcot Pty Ltd

Project:

Woolworths Leppington

116 Ingleburn Road, Leppington

#### SITE IMAGE

Level 1, 3-5 Baptist Street  
Redfern NSW 2016  
Australia

Tel: (61 2) 8332 5600  
Fax: (61 2) 9698 2877  
www.siteimage.com.au

Site Image (NSW) Pty Ltd  
ABN 44 801 262 380



Landscape Architects

#### DEVELOPMENT APPLICATION

Drawing Name:

Landscape Details

Scale: As Shown

Job Number:

SS20-4303

Drawing Number:

Issue:

502 F

NOT FOR CONSTRUCTION



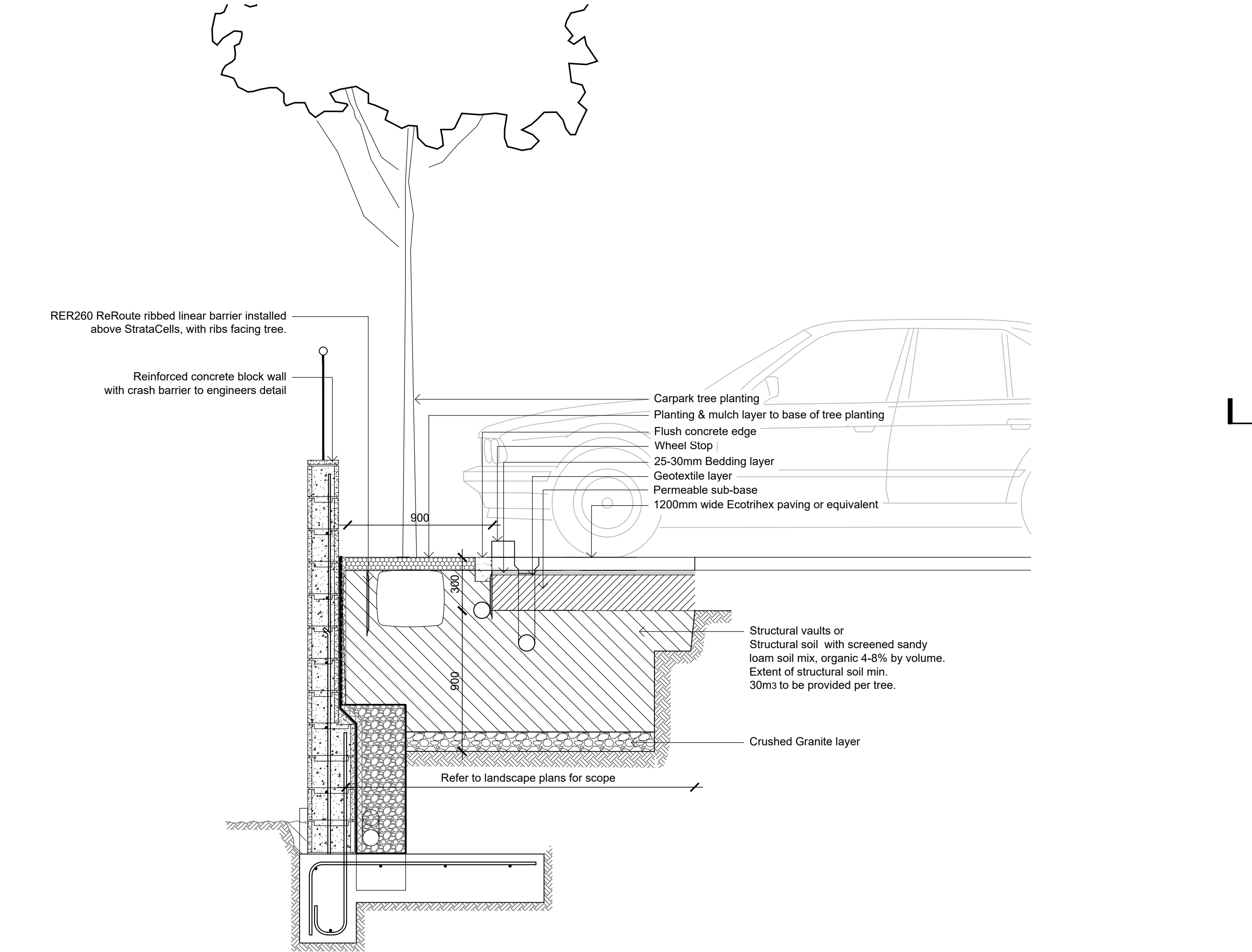

Section - Typical Tree Planting in Carpark  
1:20

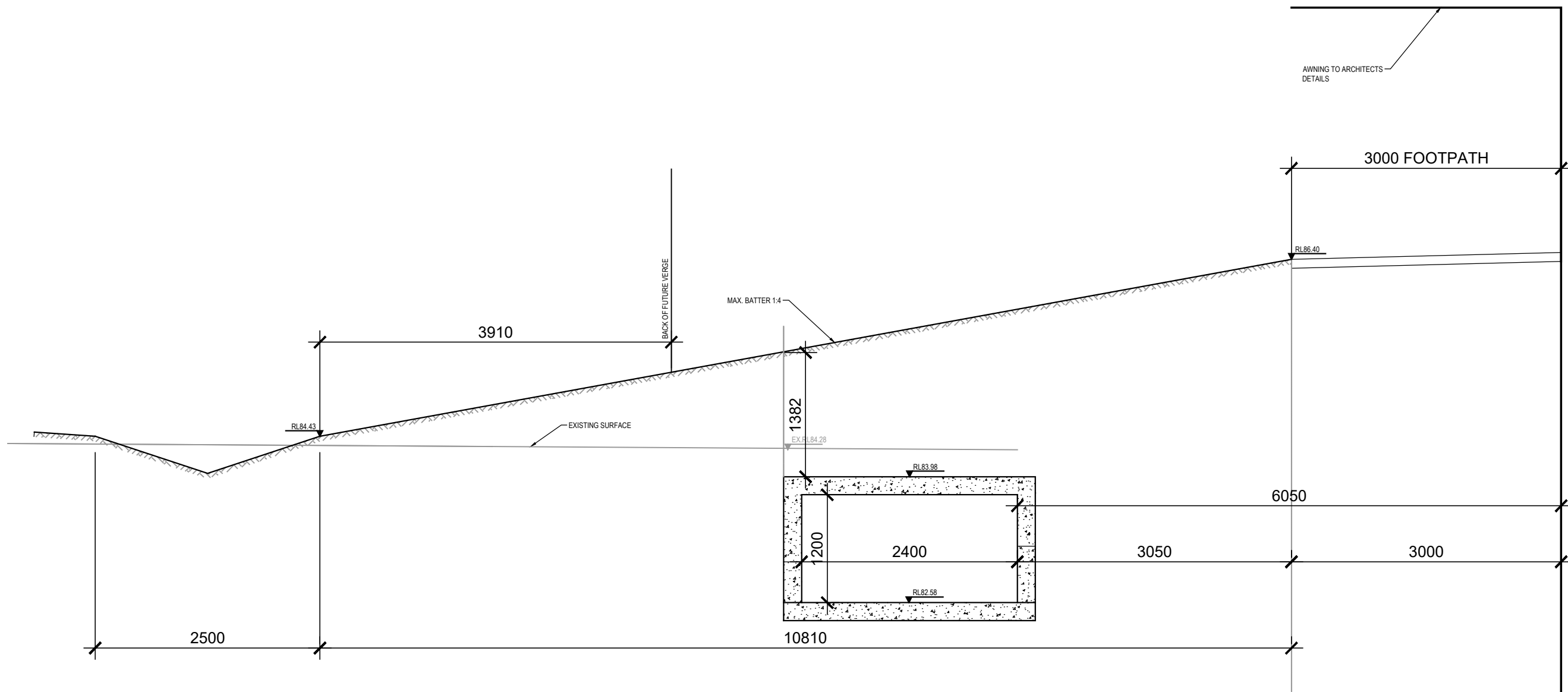

Section - Typical Embankment over culvert  
1:50

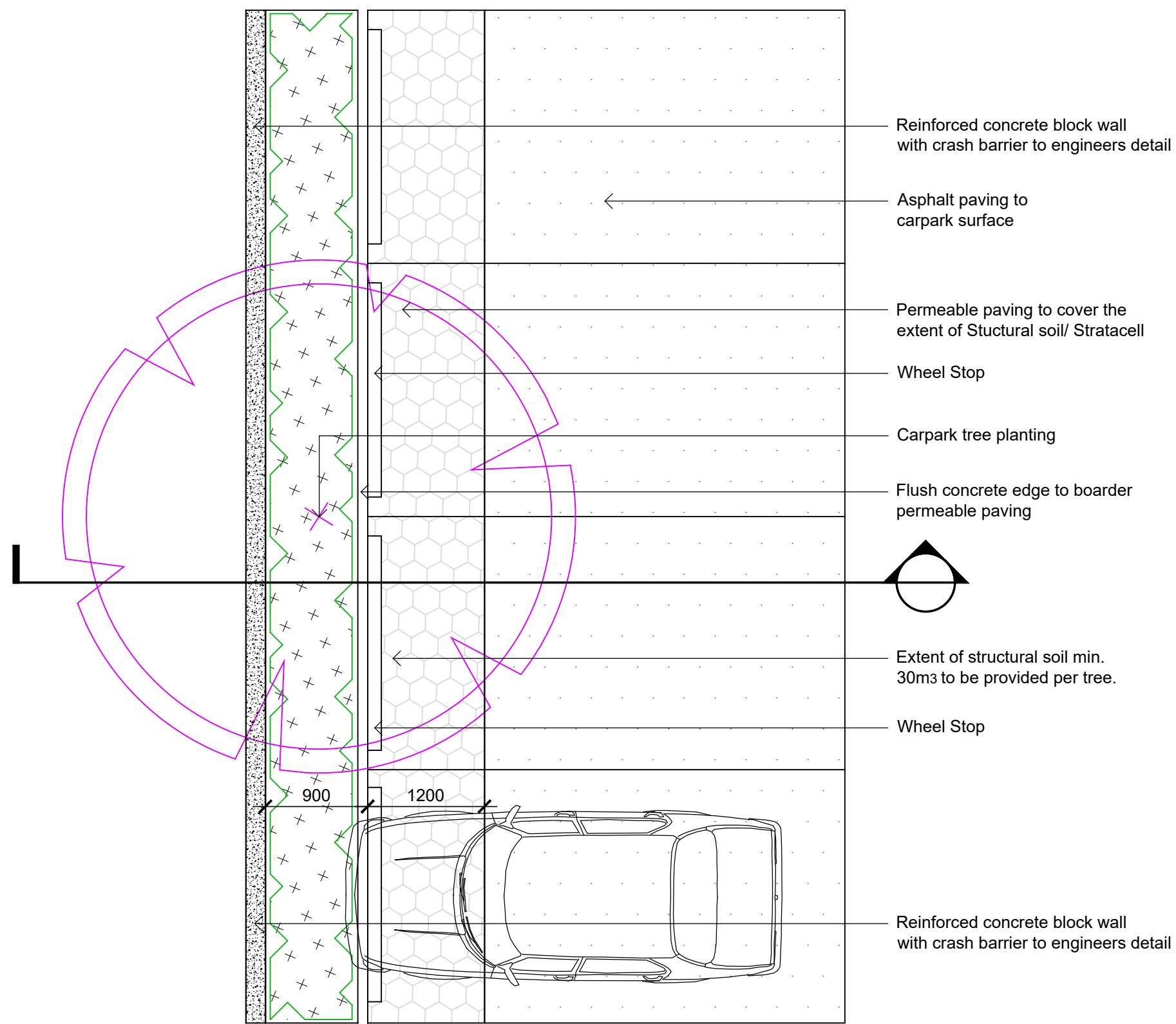

Detail Plan - Typical Tree Planting in Carpark  
1:50

#### Structural Support Soil

Structural support soil is intended for use in relation to tree planting in road verges, median strips, paved plazas and the like. This soil system is comprised of two components, a stone lattice for strength and structural support (load bearing) filler soil to service the horticultural needs of the plants. The system shall be engineered to maintain a high degree of porosity after installation and compaction and should have the characteristics listed in Table B2 below.

Table B2 – Structural Support Soil (SSS)		Physical components
Nominal 63mm hard rock aggregate (usually basalt, diorite or granite)		1 m³
Filler soil (preferably loam to clay loam)		200 L
Test methods		
AS 1141.11(2009)	AS sieve mm	% passing sieve
	63.0	100
	53	85 - 100
	37.5	20 - 65
	26.5	0 - 20
	19.0	0 - 5
	13.2	0 - 2
	4.75	0 - 1
AS 1141.24(1997)	Sodium sulphate soundness (total weight % loss)	Max. 9
Aggregate to filler soil ratio*		4.5 – 5.5

\* The aggregate to filler soil ratio test method will be:  
1. Pack mixed SSS into a calibrate 10 or 20 L bucket compacting well.  
2. Pass the entire SSS sample from the bucket over a 4.75 mm sieve.  
3. Measure the volume of fine material by pouring into a 2 L plastic measuring cylinder and dumping to firm down by dropping from 5 cm 10 times.  
4. Calculate the aggregate to filler soil ratio by dividing the total volume by the measured volume of filler soil.

Fertilisers	
Filler soil clay loam, sandy clay or clay	80 – 90% v/v
Composted soil conditioner conforming to AS 4454	10 – 20% v/v
Gypsum	500 g/m³ of filler soil
Urea	500 g/m³ of filler soil
Iron sulphate	1.5 kg/m³ of filler soil
Magnesium sulphate	400 g/m³ of filler soil
Lime or dolomite	600 g/m³ of filler soil
Potassium nitrate	500 g/m³ of filler soil
Superphosphate	500 g/m³ of filler soil
Trace element mix	300 g/m³ of filler soil
8 – 9 month controlled release	2 kg/m³ of filler soil

The ratio of filler soil to aggregate is critical in achieving the engineering and horticultural objective. The 'aggregate', 'filler soil' and blending ratio of the two shall be as specified and carefully validated. Generally, the ratio of aggregate to filler soil shall be an amount of filler soil equal to half the void space of the compacted aggregate. If the aggregate has a void space of 40% the ratio will be 10 parts aggregate by volume to 2 parts filler soil.

It should be noted that the total volume of SSS is determined by the volume of aggregate only because adding filler soil does not increase the overall volume. The filler soil takes up void space only but must be calculated as cost factor of SSS.

SSS must be a uniformly blended mixture of aggregate and filler soil and are prone to being segregated during handling at the source and during transport. Particular care must be taken to ensure that all structural soil is thoroughly mixed before placement and compaction. To assist this, and to prevent segregation, ensure that the mixture remains moist at all times during mixing, transport, storage and placement.

© 2016 Site Image (NSW) Pty Ltd ABN 44 801 262 380 as agent for Site Image NSW Partnership. All rights reserved. This drawing is copyright and shall not be reproduced or copied in any form or by any means (graphic, electronic or mechanical including photocopy) without the written permission of Site Image (NSW) Pty Ltd Any license, expressed or implied, to use this document for any purpose what so ever is restricted to the terms of the written agreement between Site Image (NSW) Pty Ltd and the instructing party.

The contractor shall check and verify all work on site (including work by others) before commencing the landscape installation. Any discrepancies are to be reported to the Project Manager or Landscape Architect prior to commencing work. Do not scale this drawing. Any required dimensions not shown shall be referred to the Landscape Architect for confirmation.

F	Architectural Coordination	JM	NM	02.02.2021
E	Architectural Coordination	JM	NM	13.11.2020
D	Architectural Coordination	JM	NM	24.09.2020
C	Updated Civil Drawings	SM	NM	30.03.2020
B	Architectural Coordination	JM	NM	25.03.2020
A	For Review	JM	NM	17.02.2020
Issue	Revision Description	Drawn	Check	Date

#### LEGEND

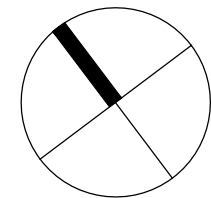

Client:

Fabcot Pty Ltd

Project:

Woolworths Leppington

116 Ingleburn Road, Leppington

SITE IMAGE

Level 1, 3-5 Baptist Street  
Redfern NSW 2016  
Australia

Tel: (61 2) 8332 5600  
Fax: (61 2) 9698 2877  
www.siteimage.com.au

Site Image (NSW) Pty Ltd  
ABN 44 801 262 380



Landscape Architects

#### DEVELOPMENT APPLICATION

Drawing Name:

Landscape Details

Scale: As Shown

Job Number:

Drawing Number:

Issue:

SS20-4303

503 F

NOT FOR CONSTRUCTION



PLANT SCHDEULE

Symbol	Botanical Name	Common Name	Mature size H x W (m)	Pot Size	Density	Quantity
<b>Trees</b>						
Ca	<i>Cupaniopsis anarcardiodes</i>	Tuckeroo	7 x 3	100L	As Shown	5
Er	<i>Elaeocarpus reticulatus</i>	Blueberry Ash	9 x 6	100L	As Shown	7
GP	<i>Ginko biloba 'Princeton Sentry'</i>	Tall Narrow Ginko	10 x 3	200L	As Shown	3
Lc	<i>Lophostemon confertus</i>	Brush Box	8 x 6	200L	As Shown	21
Li	<i>Lagerstroemia indica 'Natchez'</i>	Crepe Myrtle	8 x 6	100L	As Shown	4
Md	<i>Melaleuca decora</i>	White Cloud Tree	6 x 4	100L	As Shown	6
MLG	<i>Magnolia grandiflora 'Little Gem'</i>	Dwarf Magnolia	4 x 2	100L	As Shown	12
TL	<i>Tristaniopsis 'Lucious'</i>	Water Gum	9 x 4	100L	As Shown	27

Shrubs & Accents

CLJ	<i>Callistemon 'Little John'</i>	Bottlebrush	1 x 1	300mm	As Shown	
GP	<i>Grevillea 'Peaches &amp; Cream'</i>	Peaches & Cream Grevillea	1.5 x 2	300mm	As Shown	
MM	<i>Muraya 'Min a Min'</i>	Dwarf Murraya	1 x 1	300mm	As Shown	
PRR	<i>Photonia 'Red Robin'</i>	Red Robin	2 x 1.5	300mm	As Shown	
ST	<i>Syzygium 'Tiny Tre'</i>	Tiny Trev	0.5 x 1	300mm	As Shown	
VDF	<i>Viburnum 'Dense Fence'</i>	Dense Fence	2 x 2	300mm	As Shown	
WAB	<i>Westringia 'Aussie Box'</i>	Coastal Rosemary	1.2 x 1.2	300mm	As Shown	

Grasses & Groundcovers

DSF	<i>Dichondra 'Silver Falls'</i>	Silver Falls	0.2 x 0.5	150mm	5/m <sup>2</sup>	
DT	<i>Dianella caerulea 'Tasred'</i>	Flax Lily	0.5 x 0.5	150mm	5/m <sup>2</sup>	
Hv	<i>Hardenbergia violacea</i>	Purple Coral Pea	Spreading	150mm	5/m <sup>2</sup>	
Lm	<i>Liriope muscari 'Just Right'</i>	Lily	0.5 x 0.5	150mm	5/m <sup>2</sup>	
LN	<i>Lomandra 'Nyalla'</i>	Nyalla Lomandra	1 x 1	150mm	5/m <sup>2</sup>	
LV	<i>Lomandra longifolia 'Verday'</i>	Mat Rush	0.7 x 0.7	150mm	5/m <sup>2</sup>	
Mp	<i>Myoporum parvifolium</i>	Creeping boobialla	0.3 x 1.5	150mm	5/m <sup>2</sup>	
Tj	<i>Trachelospemum jasminoides</i>	Star Jasmine	0.3 x 1.5	150mm	5/m <sup>2</sup>	



SPECIFICATION

GENERAL NOTES

**References**  
All plans and details included in the project documents shall be read in conjunction with this specification. All structural and civil works components of the landscape design shall be referenced to engineers' details and specifications. Read this specification in conjunction with the plant and materials schedule on this drawing. If in doubt about any detail or if conflicts are found in the documents, seek advice.

**Workmanship and Materials**  
The whole of the landscape works shall be carried out by a competent, trained and qualified landscape contractor who is experienced in horticultural practices, landscape construction and planting techniques. The landscape contractor shall hold a current Building Contractors License and/or be a financial member of LNA Landscape Association NSW & ACT or equivalent organisations in other states.

EARTHWORKS

**Excavation, Trimming and Filling**  
Except as otherwise note in the contract, bulk excavation is excluded from the landscape works. Trim and fill the excavated ground surfaces to achieve design levels to accommodate finish materials as detailed. Compact the finished surface as required for the finished ground treatment.

**Sub-soil Drainage**  
Keep the excavated works drained and free of standing water. Allow to supply and install sub-soil drainage pipes as required for the new works to ensure that all gardens are well drained. Connect the sub-soil drainage pipes to the nearest downstream stormwater pits. Include pipe filter socks.

SOFTWORKS

**Soil Testing**  
Undertake at least two (2) soil tests, in locations as advised by Project Manager, and provide results and recommendations for the improvement of plant growth and to adjust the soil to achieve appropriate planting medium (including pit levels) for successful plant growth.

**Subsoil**  
Excavate all garden beds to bring the subsoil to at least 300mm below finished design levels. Shape the subsoil to fall to subsoil drains where applicable. Do not excavate within the drip line of trees to be retained. Excavate all turf areas to bring the subsoil to at least 100mm below finished design levels. Shape the subsoil to fall to subsoil drains where applicable. Do not excavate within the drip line of trees to be retained. Cultivate the subsoil to a further depth of 100mm. Remove stones exceeding 25mm, clods of earth exceeding 50mm, and weeds, rubbish or other deleterious material brought to the surface during cultivation. Do not disturb services or tree roots, if necessary cultivate these areas by hand. During cultivation, thoroughly mix in materials required to be incorporated into the subsoil, as recommended in the soil testing results and to manufacturer's recommendations. Trim the surface to design levels after cultivation.

**Topsoil**  
Import topsoil for the garden and turf areas, unless the topsoil can be provided from material recovered from the site, as recommended in the soil testing results. Spread the topsoil on the prepared subsoil and grade evenly, compact lightly and uniformly in 150mm layers. Avoid differential subsidence and excess compaction and produce a finished topsoil surface which has the following characteristics:  
• Finished to design levels, allowing for mulch or turf, which is to finish flush with adjoining hard surfaces such as paths and edge;  
• Smooth and free from stones or lumps of soil;  
• Graded to drain freely, without ponding, to catchment points;  
• Graded evenly to adjoining surfaces; and  
• Ready for planting.

**Compost**  
Provide, in accordance with AS 4454, well rotted vegetative material or animal manure, free from harmful chemicals, grass and weed growth.

**Fertiliser**  
Provide proprietary fertilisers, delivered to the site in sealed bags

marked to show manufacturer or vendor, weight, fertiliser type, N-P-K ratio, recommended uses and application rates.

**Plants**  
Supply plants in accordance with the landscape drawings and schedules, which have the following characteristics:  
• Large healthy root systems, with no evidence of root curl, restriction or damage;  
• Vigorous, well established, free from disease and pests, of good form consistent with the species or variety;  
• Hardened off, not soft or forced, and suitable for planting in the natural climatic conditions prevailing at the site, and in particular shade conditions;  
• Grown in final containers for not less than twelve weeks;  
• Trees, unless required to be multi-stemmed, shall have a single leading shoot; and  
• Containers shall be free from weeds and of appropriate size in relation to their container.

**Plant Installation**  
Following excavation of the planting hole place and spread 15gms of wetting agent pre-mixed with one (1) litre of water. Place the plant correctly orientated to north or for best presentation. Backfill the planting holes with specified topsoil mixture. Lightly tamp and water to eliminate air pockets. Ensure the topsoil is not placed over the top of the rootball. Keep the plant stem at the same height above the ground as it was above the soil in the container. Apply fertiliser, as recommended in the soil testing results or in accordance with the manufacturer's recommendations around the plants in the soil at the time of planting.

**Root Barrier**  
Supply and install root control barriers to all new tree plantings adjacent to walls, paths and all trunk service trenches, where their proximity poses a threat to the stability of the infrastructure. Install in accordance with manufacturer's recommendations.

**Mulch**  
Mulch shall be approved recycled wood fibre or pine bark mulch. Place mulch in all garden beds to a depth of 75mm, after all specified plants are installed. Keep mulch clear of all plant stems and rake to an even surface flush with the surrounding surfaces evenly graded between design surface levels. Over fill to allow mulch to settle to the specified depth.

**Stakes and Ties**  
Stakes shall be durable hardwood, straight, free of knots and twists, pointed at one end, in the following quantities and sizes for each of the various plant pot sizes:  
• Plants (>25 lt): 1 off 38 x 38 x 1200mm;  
• Semi-advanced plants (>75 lt): 2 off 50x50x 1800mm;  
• Advanced (>100 lt): 3 off 50 x 50 x 2400mm.

IRRIGATION

All proposed landscape areas shall be irrigated.

The irrigation system shall be an automatic fixed drip system, with an irrigation controller self operated via a soil moisture sensor. The system shall be compatible to the type of plant material and rates of water required. Where appropriate adjustable and fully serviceable. The layout of the entire irrigation is to ensure that each individual plant receives the required amount of water to maintain healthy and vigorous growth. The irrigation system shall be such that, component theft, vandalism, over-spray and wetting of paths shall be reduced to a minimum or completely eliminated by the use of drip, pop-up sprinklers and judiciously placed fixed spray emitters. Do not use fine mist type emitters that provide a drifting mist that may wet paths and the buildings.

LANDSCAPE MAINTENANCE

The Landscape Contractor shall rectify defects during installation and that become apparent in the works under normal use for the duration of the contract Defects Liability Period. The Landscape Contractor shall maintain the contract areas by the implementation of industry accepted horticultural practices for 52 weeks. The landscape maintenance works shall include, but not be limited to, the following:  
• Replacing failed plants;

- Pruning;
- Insect and pest control;
- Fertilising;
- Stakes and ties;
- Maintaining mulch;
- Moving and top dressing;
- Irrigation and watering;
- Erosion control; and
- Weeding and rubbish removal.

**Maintenance Log Book**  
Implement and keep a maintenance log book recording when and what maintenance work has been undertaken and what materials, actions and decisions have been used, implemented and concluded to keep the landscape always looking its best.

**Maintenance Activities**  
Schedule the following activities to occur on a timely basis.

- **Plant replacement** - Replace plants that have failed to mature, die or are damaged. Replacement plants shall be in a similar size and quality and identical species or variety to the plant that has failed. Replacement of plants shall be at the cost of the landscape contractor unless advised otherwise. If the cause of the failure is due to a controllable situation then correct the situation prior to replacing plants.
- **Pruning** - Prune dead wood, broken limbs, dead or infected foliage and as needed to develop strong, healthy plants to achieve the shape and end expectation of the plant type.
- **Insect and pest control** - Avoid spraying:
  - if ever possible;
  - in wet weather or if wet weather is imminent;
  - if target plants are still wet after rain;
  - in windy weather; and
  - if non-target species are too close.Immediately report to the Project Manager any evidence of intensive weed infestation, insect attack or disease amongst plant material. Submit all proposals to apply chemicals and obtain approval before starting this work. When approved, spray with herbicide, insecticide, fungicide as appropriate in accordance with the manufacturers' recommendations. Record in the logbook all relevant details of spraying activities including:
  - Product brand / manufacturer's name,
  - Chemical / product name,
  - Chemical contents,
  - Application quantity and rate,
  - Date of application and location,
  - Results of application, and
  - Use approval authority.
- **Fertilising** - Fertilise gardens with a proprietary slow release fertiliser applied in accordance with the manufacturer's directions and recommendations. Record in the logbook all relevant details of fertilising including:
  - Product brand / manufacturer's name,
  - Fertiliser / product name,
  - Application quantity and rate, and
  - Date of application and location.
- **Stakes and ties** - Adjust and replace as required to ensure plants remain correctly staked. Remove those not required at the end of the planting establishment period (Defects Liability Period).
- **Maintaining mulch** - Maintain the surface in a clean, tidy and weed free condition and reinstate the mulch as necessary to ensure correct depth as specified.
- **Irrigation and watering** - Maintain the irrigation system to sure that each individual plant receives the required amount of water to maintain healthy and vigorous growth, adjust and rectify as required. Provide additional watering, if necessary.
- **Erosion control** - Where necessary, maintain the erosion control devices in a tidy and weed free condition and reinstate as necessary to ensure control measures are effective where deemed necessary.
- **Weeding and rubbish removal** - During the plant establishment period remove by hand, rubbish and weed growth that may occur or re-occur throughout all planted, mulched and paved areas. The contractor shall target weeds that are capable of producing a major infestation of unwanted plants by seed distribution. Whenever possible, time weed removal to precede flowering and seed set.

© 2016 Site Image (NSW) Pty Ltd ABN 44 801 262 380 as agent for Site Image NSW Partnership. All rights reserved. This drawing is copyright and shall not be reproduced or copied in any form or by any means (graphic, electronic or mechanical including photocopy) without the written permission of Site Image (NSW) Pty Ltd Any license, expressed or implied, to use this document for any purpose what so ever is restricted to the terms of the written agreement between Site Image (NSW) Pty Ltd and the instructing party.

The contractor shall check and verify all work on site (including work by others) before commencing the landscape installation. Any discrepancies are to be reported to the Project Manager or Landscape Architect prior to commencing work. Do not scale this drawing. Any required dimensions not shown shall be referred to the Landscape Architect for confirmation.

F	Architectural Coordination	JM	NM	02.02.2021
E	Architectural Coordination	JM	NM	13.11.2020
D	Architectural Coordination	JM	NM	24.09.2020
C	Updated Civil Drawings	SM	NM	30.03.2020
B	Architectural Coordination	JM	NM	25.03.2020
A	For Review	JM	NM	17.02.2020
Issue	Revision Description	Drawn	Check	Date

LEGEND

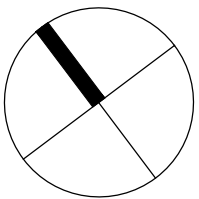

Client:  
**Fabcot Pty Ltd**

Project:  
**Woolworths Leppington**  
**116 Ingleburn Road, Leppington**

**S I T E I M A G E**  
Level 1, 3-5 Baptist Street  
Redfern NSW 2016  
Australia  
Tel: (61 2) 8332 8600  
Fax: (61 2) 9898 2877  
www.siteimage.com.au  
Site Image (NSW) Pty Ltd  
ABN 44 801 262 380  
  
Landscape Architects

DEVELOPMENT APPLICATION

Drawing Name:  
**Landscape Specification**

Scale: **As Shown**  
Job Number: **SS20-4303**  
Drawing Number:  
Issue: **504 F**

NOT FOR CONSTRUCTION